

DC EXHIBIT F

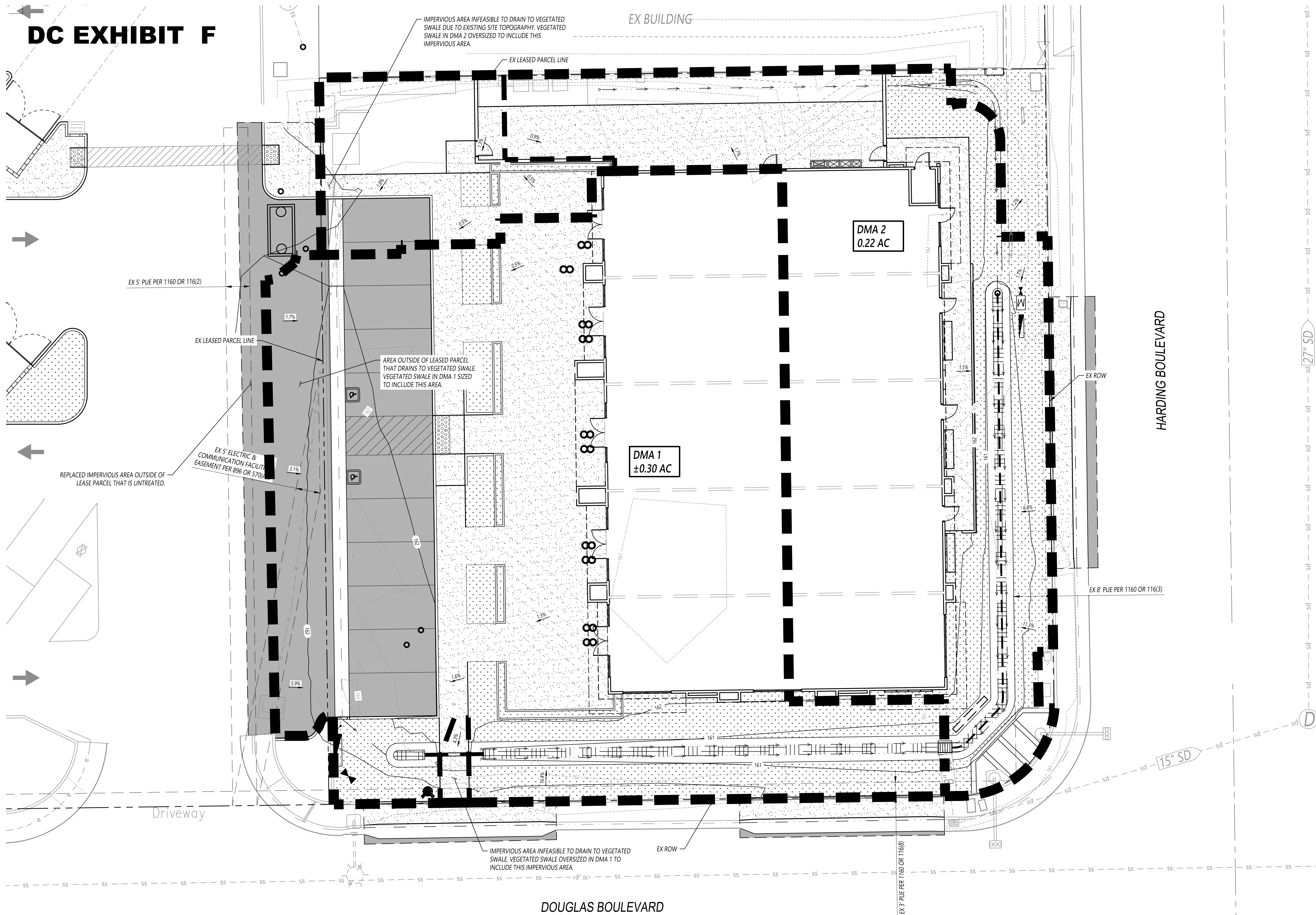

LEGEND

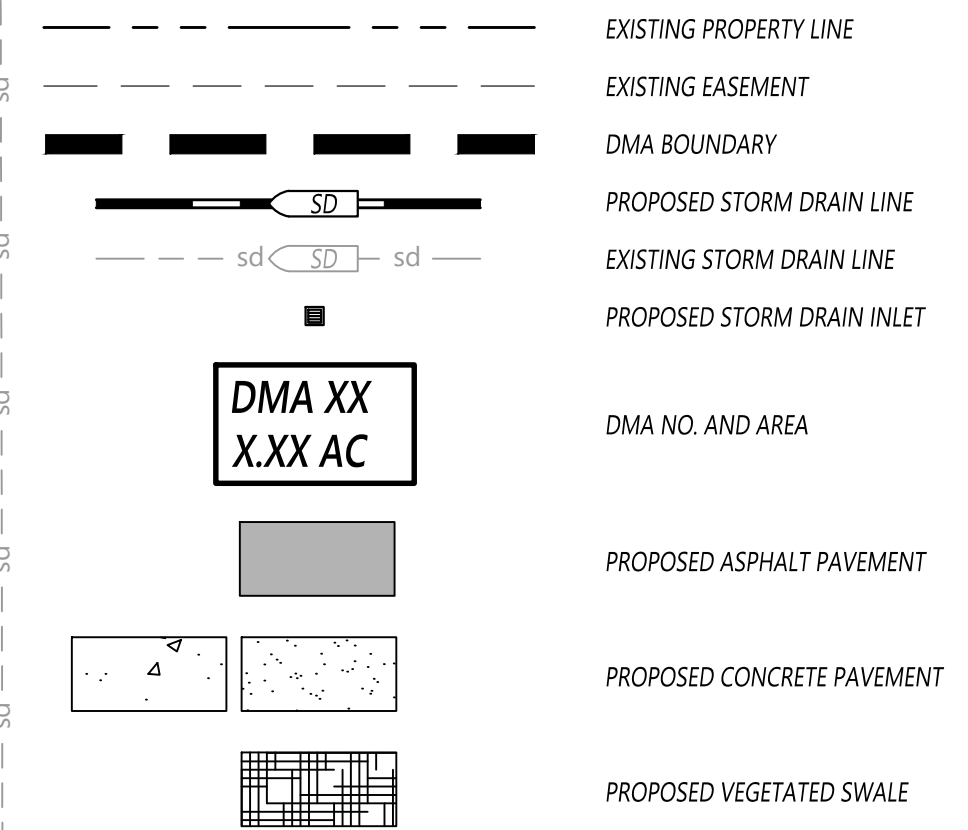

IMPERVIOUS SURFACE INFORMATION

TOTAL GROSS LEASED PARCEL AREA: ±0.51 AC (± 22,414 SF)

EXISTING ON-SITE IMPERVIOUS SURFACING	
IMPERVIOUS AREA:	±0.43 ACRES (18,603 SF) - 83% OF TOTAL
TOTAL EXISTING IMPERVIOUS	±0.43 ACRES (18,603 SF) - 83% OF TOTAL
EXISTING ON-SITE PERVIOUS SURFACING	
LANDSCAPE AREA:	±0.08 ACRES (3,811 SF) - 17% OF TOTAL
TOTAL EXISTING PERVIOUS	±0.08 ACRES (3,811 SF) - 17% OF TOTAL
PROPOSED ON-SITE IMPERVIOUS SURFACING	
PAVED/BUILDING AREA:	±0.35 ACRES (15,418 SF) - 69% OF TOTAL
TOTAL PROPOSED IMPERVIOUS	±0.35 ACRES (15,418 SF) - 69% OF TOTAL
PROPOSED ON-SITE PERVIOUS SURFACING	
LANDSCAPE AREA:	±0.16 ACRES (6,996 SF) - 31% OF TOTAL
TOTAL PROPOSED PERVIOUS	±0.16 ACRES (6,996 SF) - 31% OF TOTAL

PRELIMINARY STORMWATER QUALITY NOTES:

- THIS PROJECT IS CONSIDERED A REGULATED REDEVELOPMENT PROJECT BECAUSE IT CREATES/REPLACES MORE THAN 5,000 SF OF IMPERVIOUS AREA ON A PREVIOUSLY DEVELOPED AREA. THE REDEVELOPMENT PROJECT RESULTS IN AN INCREASE OF LESS THAN 50% OF IMPERVIOUS AREA FROM THE PREVIOUS EXISTING DEVELOPMENT. THEREFORE, ONLY RUNOFF FROM THE NEW/REPLACED IMPERVIOUS SURFACE WILL BE TREATED. TREATMENT WILL BE PROVIDED VIA VEGETATED SWALES TO MEET THE REQUIREMENTS IN THE WEST PLACER STORM WATER QUALITY DESIGN MANUAL AND SPREADSHEET. A FULL TRASH CAPTURE SCREEN WILL BE USED AT THE DOWNSTREAM INLET TO MEET STATEWIDE FULL TRASH CAPTURE REQUIREMENTS.

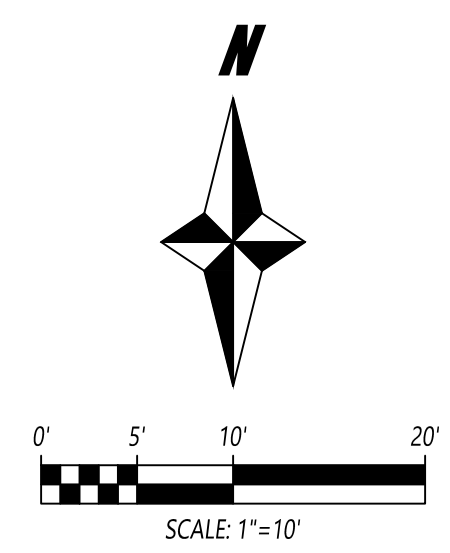

PRELIMINARY STORMWATER QUALITY CONTROL PLAN ROSEVILLE SQUARE

445 ROSEVILLE SQUARE
ROSEVILLE, CA 95678

CARTWRIGHT NOR CAL
CIVIL ENGINEERING & PROJECT MANAGEMENT

3010 LAVA RIDGE COURT, SUITE 160
ROSEVILLE, CALIFORNIA 95661
T (916) 978-4001
WWW.CARTWRIGHTENGINEERS.COM

C3.0

DATE: 04/22/2024
SCALE: 1"=10'
DRAWN BY: WY

Login Name: mcalicw
 Plot Date: April 22, 2024 - 3:05 pm
 File Name: U:\22307-Roseville Square\Revela\Cad\LD\Production Drawings\22307-00-SWQCP.dwg